

© COPYRIGHT OF THIS DRAWING IS RESERVED BY DBFL CONSULTING ENGINEERS. NO PART SHALL BE REPRODUCED OR TRANSMITTED WITHOUT THEIR WRITTEN PERMISSION.

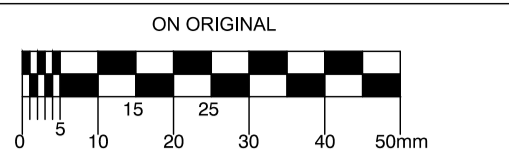

- NOTES:
- GENERAL NOTES:
1. ALL WORKS SHALL BE CONSTRUCTED IN ACCORDANCE WITH THE NRA SPECIFICATION FOR ROAD WORKS.
  2. ALL DIMENSIONS IN METRES UNLESS SPECIFIED OTHERWISE.
  3. ALL CO-ORDINATES ARE TO IRISH TRANSVERSE MERCATOR (TM).
  4. ALL LEVELS ARE TO ORDNANCE DATUM AND ARE IN METRES.
  5. ALL TEMPORARY TRAFFIC & OPERATIONS MANAGEMENT SHALL COMPLY FULLY WITH THE NRA SPECIFICATION FOR ROAD WORKS.
  6. THE CONTRACTOR MUST LIAISE DIRECTLY WITH MEATH COUNTY COUNCIL AS REQUIRED.
  7. ALL VEHICULAR & OPERATIONAL ROUTES WITHIN AND SURROUNDING THE WORKS EXTENTS MUST BE MAINTAINED THROUGHOUT THE WORKS IN ACCORDANCE WITH THE CONTRACTORS APPROVED TEMPORARY TRAFFIC & OPERATIONS MANAGEMENT PLAN AND SHALL COMPLY FULLY WITH THE PROVISIONS OF CH.8 OF THE TRAFFIC SIGNS MANUAL.
  8. CONTRACTOR SHALL EMPLOY THE SERVICES OF AN APPROVED SURVEY COMPANY TO ESTABLISH THE GRID IDENTIFIED THROUGHOUT THE WORKS.
  9. ALL AGGREGATES PROPOSED FOR USE ON THIS SCHEME SHALL MEET FULLY THE REQUIREMENTS OF THE NRA SPECIFICATION FOR ROAD WORKS AND IN ADDITION THE REQUIREMENTS STATED IN STANDARD RECOMMENDATION S.R. 21:2014 GUIDANCE ON THE USE OF I.S. EN 13242-2002 +A1:2007 - AGGREGATES FOR UNBOUND AND HYDRAULICALLY BOUND MATERIALS FOR USE IN CIVIL ENGINEERING WORK AND ROAD CONSTRUCTION.
- DRAWING SPECIFIC NOTES:
1. REFER TO DRGS 170092-2000 TO 2004 FOR HORIZONTAL ALIGNMENT INFORMATION.
  2. REFER TO DRG 170092-2011 FOR TYPICAL CROSS SECTIONAL CONSTRUCTION DETAILS.

KEY

----- EXISTING GROUND PROFILE  
 ----- PROPOSED GROUND PROFILE STRAIGHT  
 ----- PROPOSED GROUND PROFILE CURVE

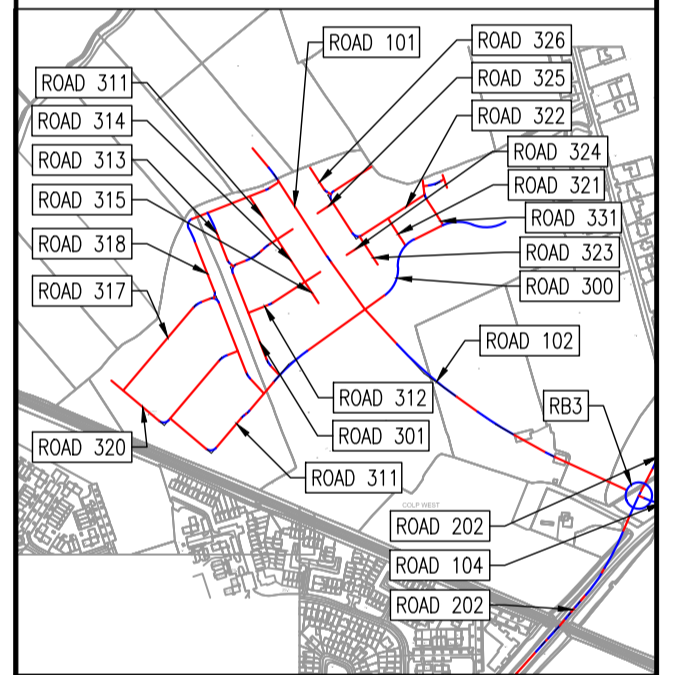

KEYPLAN

REV.	DATE	DESCRIPTION	BY	CHKD.
<b>PLANNING SHD STAGE 3</b>				
DESIGNED	DMW	PREPARED	DJG	
DATE	OCT 2019	CHECKED	DJR	

**DBFL** Dublin Office: Ormrod House, Upper Ormrod Quay, Dublin 7, Ireland. PHONE +353 1 400 4000 FAX +353 1 400 4050

Waterford Office: Unit 2, The Chandery, 1-2 O'Connell Street, Waterford, Ireland. PHONE +353 51 308 500 FAX +353 51 844 813

DBFL Consulting Engineers email: info@dbfl.ie site: www.dbfl.ie

PROJECT  
**STRATEGIC HOUSING DEVELOPMENT AT COLPE WEST, DROGHEDA, CO. MEATH**

DRG. TITLE  
**LONGITUDINAL SECTIONS THROUGH ROAD SHEET 3**

CLIENT  
**SHANNON HOMES DROGHEDA LTD.**

SCALE AS SHOWN @A1 FILE REF. 170092-2071  
 DRG. NO. **170092-2073**

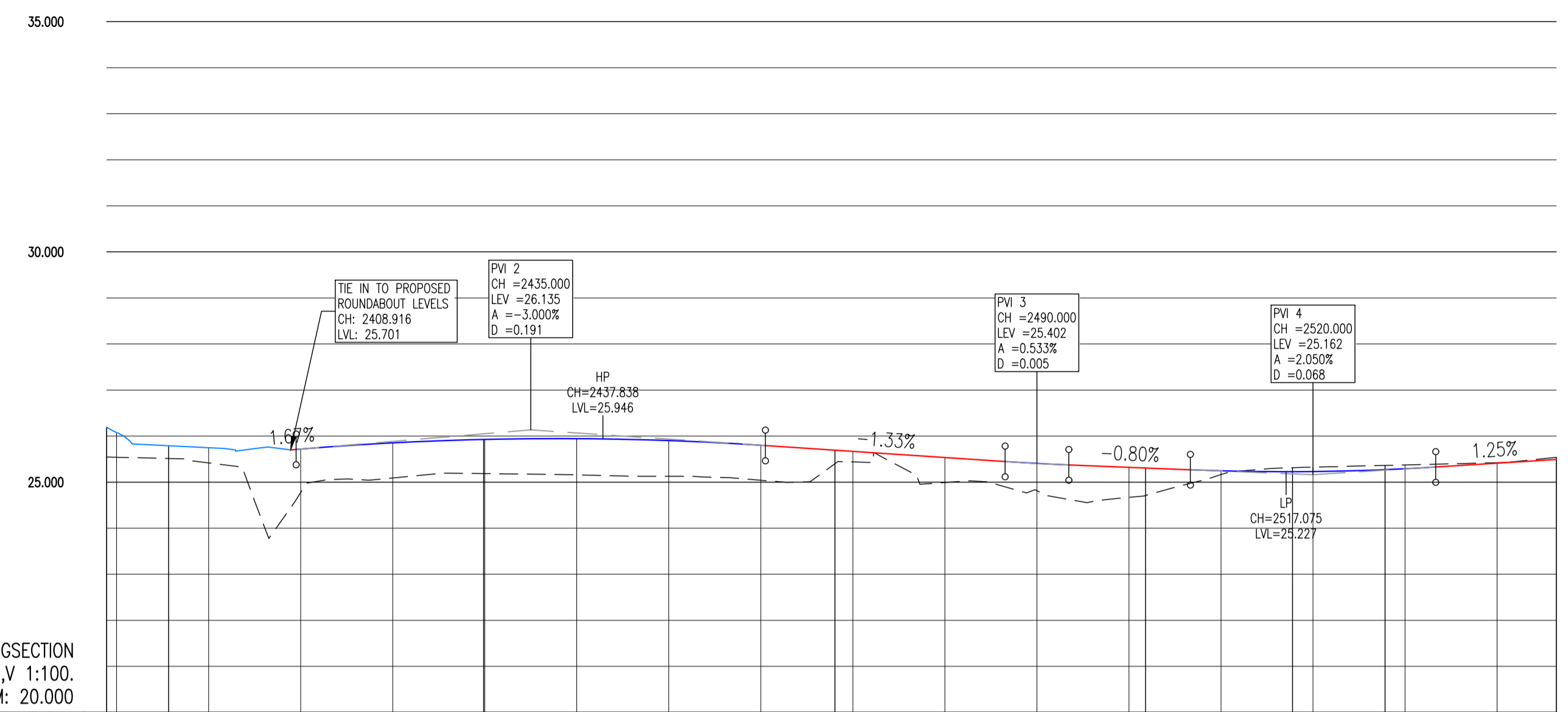

ROAD 202 LONGSECTION  
 SCALE: H 1:500, V 1:100.  
 DATUM: 20.000

CHAINAGE	EXISTING GROUND LEVELS	PROPOSED LEVELS	VERTICAL GEOMETRY	HORIZONTAL GEOMETRY
2380.000	25.546			R: 416.200 L: 6.730
2400.000	25.418			
2410.000	24.773	25.719	G = 1.667% 1.50	L = 34.227
2420.000	25.092	25.853		
2430.000	25.186	25.928		R: 366.569 L: 38.172
2440.000	25.157	25.945		
2450.000	25.127	25.903		
2460.000	25.041	25.802	G = -1.333% -1.75	R: 105.755 L: 33.754
2470.000	25.439	25.669		
2480.000	24.992	25.535		R: 127.000 L: 15.964
2490.000	24.815	25.407		
2500.000	24.670	25.322	G = -0.800% -1.125	R: 1300.000 K = 13.000 L = 26.650
2510.000	25.164	25.246		
2520.000	25.326	25.230		R: 53.000 L: 10.055
2530.000	25.374	25.291		
2540.000	25.423	25.412	G = 1.250% 1.80	L = 18.605
2546.429	25.539	25.483		

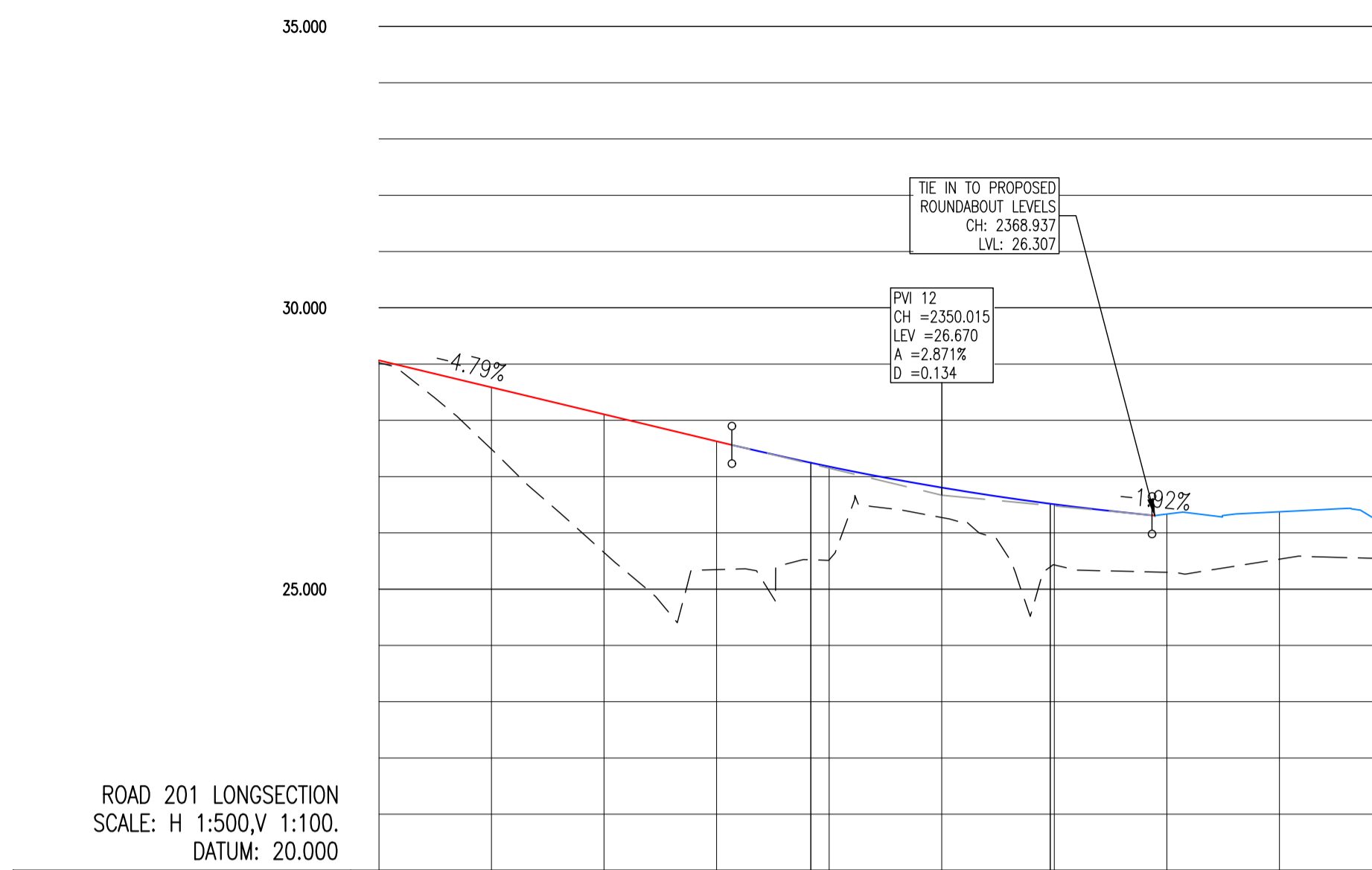

ROAD 201 LONGSECTION  
 SCALE: H 1:500, V 1:100.  
 DATUM: 20.000

CHAINAGE	EXISTING GROUND LEVELS	PROPOSED LEVELS	VERTICAL GEOMETRY	HORIZONTAL GEOMETRY
2300.000	29.024	29.064		R: 400.002 L: 55.663
2310.000	27.486	28.586		
2320.000	25.651	28.107	G = -4.788% -1.21	
2330.000	25.347	27.628		
2340.000	25.521	27.178		L = 21.263
2350.000	26.273	26.804		
2360.000	25.431	26.508	R = 1300.000 K = 13.000 L = 37.329	
2370.000	25.299		G = -1.916% -1.52	R: 416.200 L: 29.301
2380.000	25.533			
2386.338	25.546			

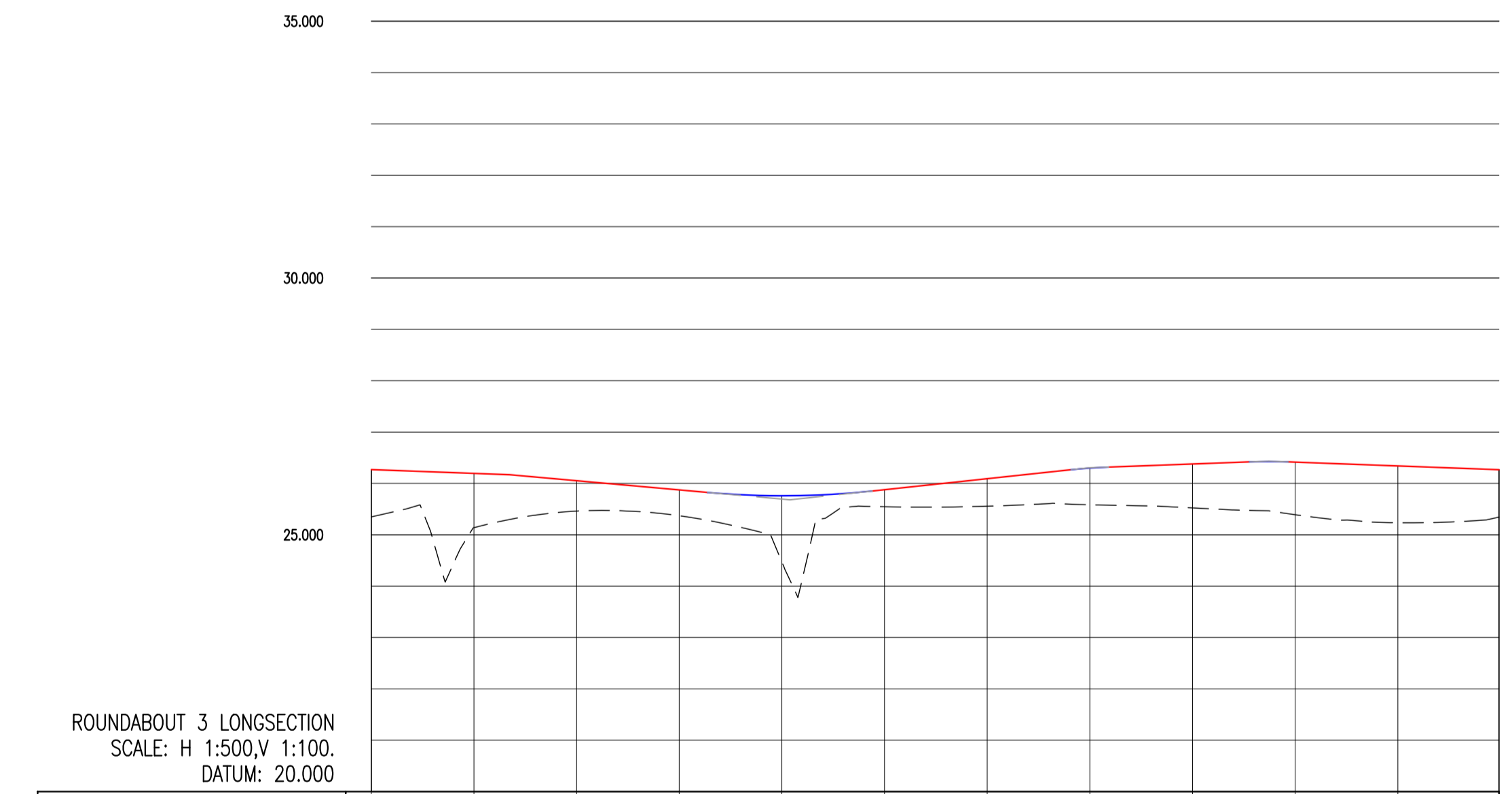

ROUNDABOUT 3 LONGSECTION  
 SCALE: H 1:500, V 1:100.  
 DATUM: 20.000

CHAINAGE	EXISTING GROUND LEVELS	PROPOSED LEVELS	VERTICAL GEOMETRY	HORIZONTAL GEOMETRY
300.000	25.349	25.268		
310.000	25.138	25.195		
320.000	25.462	25.053	G = -0.735% -1.136	
330.000	25.371	25.874	G = -1.786% -1.56	
340.000	24.471	25.760		R = 410.000 K = 4.100 L = 16.073
350.000	25.345	25.878		
360.000	25.557	26.092	G = 2.135% 1.47	
370.000	25.584	26.299		R = 260.000 K = 2.600 L = 3.682
380.000	25.523	26.378	G = 0.730% 1.137	
390.000	25.391	26.414		R = 260.000 K = 2.600 L = 3.680
400.000	25.235	26.340	G = -0.735% -1.136	
409.856	25.344	26.268		L = 109.856